

## PROPERTIES



### FEATURES

- ▶ for spanning larger distances between shaft ends
- ▶ standard lengths up to 6 meters
- ▶ no intermediate support bearings required
- ▶ extremely straight and laterally stiff intermediate tube

### MATERIAL

- ▶ **Bellows:** high grade stainless steel

- ▶ **Intermediate tube:** steel, optional CFK

- ▶ **Hubs:** steel

### DESIGN

Two conical clamping bushings with separate screws for mounting and dismounting. A special support system carries the weight of the tube on the hubs. Operable temperature range from -30 to +100 °C.

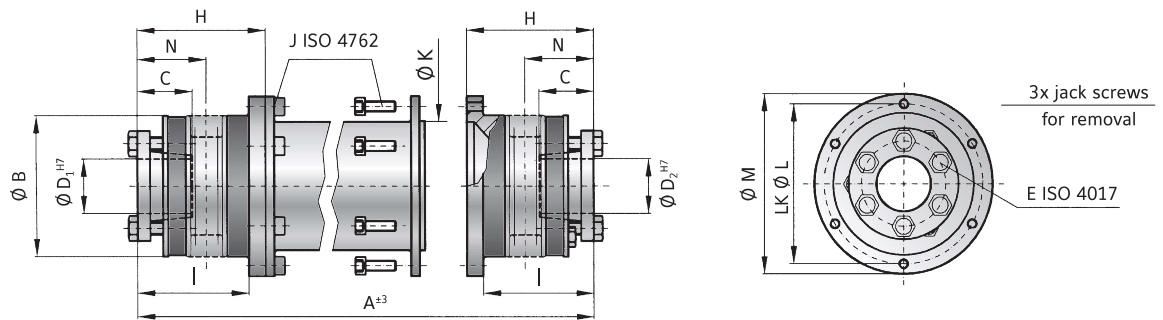

## MODEL MBL

SIZE			1500	4000
Rated torque	(Nm)	$T_{KN}$	1500	4000
Overall length min. to max.	(mm)	$A_{\pm 3}$	280 – 6000	280 – 6000
Outside diameter	(mm)	B	157	200
Fit length	(mm)	C	61	80.5
Inside diameter from $\emptyset$ to $\emptyset$ H7	(mm)	$D_{1/2}$	35 – 70	40 – 100
ISO 4017 clamping screws		E	6 x M12	6 x M16
Tightening torque	(Nm)		70	120
Length bellows body	(mm)	H	98	103.5
Distance	(mm)	I	82	84
ISO 4762 clamping screws		J	10x M10	12x M12
Tightening torque	(Nm)		70	120
Outside diameter tube section	(mm)	K	150	160
Bolt hole circle $\emptyset$	(mm)	L	168	193
Outside diameter flange	(mm)	M	184	213
Shaft average value	(mm)	N	56	61

For maximum misalignment values see page 16.

ORDERING EXAMPLE	MBL	1500	2551	50.8	70	XX
Model	●					Special designation only (e.g. special bore tolerance).
Size		●				
Overall length mm			●			
Bore D1 H7				●		
Bore D2 H7					●	
For custom features place an XX at the end of the part number and describe the special requirements (e.g. ZA / 1500 / 2551 / 50.8 / 70 / XX; XX=stainless steel)						